

## 22.8" ColorWash LED Wall Washer ETL Rated



This production is mainly used for decorating and high-lighting in building frame, garden, etc. It can work in independent mode and DMX mode, which can generate various color changing effects, such as flashing, fading, steady, seven color jumping synchronously etc. DMX256 class gray degree dimmer, DMX programmable (thousands of effects available if many lights being connected together).

### A. Specification

#### A-1. Structure

Materials of Shell: Aluminum alloy/6063

Rotary angle: 180°

Input Voltage: 100V-240V AC

Operating Voltage: 24V DC

Protecting Rating: IP65

Operating Temperature: -20C~40C

#### A-2. Model Configuration Table

| Model No.     | LED Color          | LED Quantity | Power Consumption | Beam Angle  | Size                 | Weight    | ✓ |
|---------------|--------------------|--------------|-------------------|-------------|----------------------|-----------|---|
| LWW/LFL-5-12P | R, G, B/WW/NW/W    | 12           | 15 WATTS          | 10°/20°/45° | 440x147/78x70/118mm  | 2.35kg±5% |   |
| LWW/LFL-5-18P | R, G, B/WW/NW/W    | 18           | 20 WATTS          | 10°/20°/45° | 580x147/78x70/118mm  | 2.80kg±5% |   |
| LWW/LFL-5-24P | R, G, B/WW/NW/W    | 24           | 26 WATTS          | 10°/20°/45° | 840x147/78x70/118mm  | 3.73kg±5% |   |
| LWW/LFL-5-30P | R, G, B/WW/NW/W    | 30           | 35 WATTS          | 10°/20°/45° | 1000x147/78x70/118mm | 4.15kg±5% |   |
| LWW/LFL-5-36P | R, G, B/WW/NW/W    | 36           | 40 WATTS          | 10°/20°/45° | 1120x147/78x70/118mm | 4.5kg±5%  |   |
| LWW/LFL-5-48P | R, G, B, W/WW/NW/W | 48           | 52 WATTS          | 15°/25°/40° | 1240x147/78x70/118mm | 5.22kg±5% |   |

### B. Working Mode:

B-1. Independent Mode: Choose the build-in programs via the buttons on the end cover.

B-2. DMX Mode: International standard DMX 512 signal (IP68 connector).

B-3. Master/Slave Mode: Auto online and synchron working.

# 22.8" ColorWash LED Wall Washer ETL Rated

## C. Function & Setup

### C-1. Independent Mode

After pressing A four times (the first three times is the setup on DMX address) or B directly, light enter into independent mode; the digital LEDs show PXY, press A once, active digital LEDs move backward, you can choose function via X and parameter via Y; Press B, the corresponding flash digital LED increases one bit (range: 1~9).



X refers to functions (the value between 1 to b), Y refers to value of speed and gray degree for the functions (the value between 1 to 9). When pressing button, please wait for about 10 sec, then you can exit the mode of adjustment function, the digital LED stop flashing and data recorded.

Function and parameter sheet:

| X value         | Y value               |
|-----------------|-----------------------|
| 1-static red    | 1~9 class gray degree |
| 2-static green  | 1~9 class gray degree |
| 3-static yellow | 1~9 class gray degree |
| 4-static blue   | 1~9 class gray degree |
| 5-static purple | 1~9 class gray degree |
| 6-static cyan   | 1~9 class gray degree |

| X value               | Y value               |
|-----------------------|-----------------------|
| 7-staic white         | 1~9 class gray degree |
| 8-multicolor changing | 1~9 class speed       |
| 9-single fading       | 1~9 class speed       |
| A-multicolor fading   | 1~9 class speed       |
| B-multicolor flashing | 1~9 class speed       |
| C-autorun             | 1~9 times circle      |

### C-2. DMX Mode

#### 1. DMX Addressing

When the digital LED is not flashing, press A, digital LED begin to flash, press A once, active digital LEDs moves backward, you can start to edit the second digital LED; Press B, the corresponding flash digital LED increase one bit (the values between 1 to 9).

#### 2. DMX Channel instruction-3 Channels available as sheet:

| CHANNEL 1 |                   | CHANNEL 2 |                     | CHANNEL 3 |                    |
|-----------|-------------------|-----------|---------------------|-----------|--------------------|
| Data      | Function          | Data      | Function            | Data      | Function           |
| 0~255     | Brightness of Red | 0~255     | Brightness of Green | 0~255     | Brightness of Blue |

\*\*\*Enter or quit DMX mode automatically once detecting valid signal!!!

# 22.8" ColorWash LED Wall Washer ETL Rated

3. DMX Channel instruction-4 Channels available as sheet:

| CHANNEL 1 |                   | CHANNEL 2 |                     | CHANNEL 3 |                    | CHANNEL 4 |                     |
|-----------|-------------------|-----------|---------------------|-----------|--------------------|-----------|---------------------|
| Data      | Function          | Data      | Function            | Data      | Function           | Data      | Function            |
| 0~255     | Brightness of Red | 0~255     | Brightness of Green | 0~255     | Brightness of Blue | 0~255     | Brightness of White |

\*\*\*Enter or quit DMX mode automatically once detecting valid signal!!!

### C-3. Master/Slave Mode

Choose any one light as the master for attaining auto online function, the operations are as below: firstly, set the address of master as 001, others are set as slave (address can be any one except 001); Change function of the master (001) light, then all lights will work synchronously;

### D. Photometric Parameters

#### D-1. Cadela Distribution

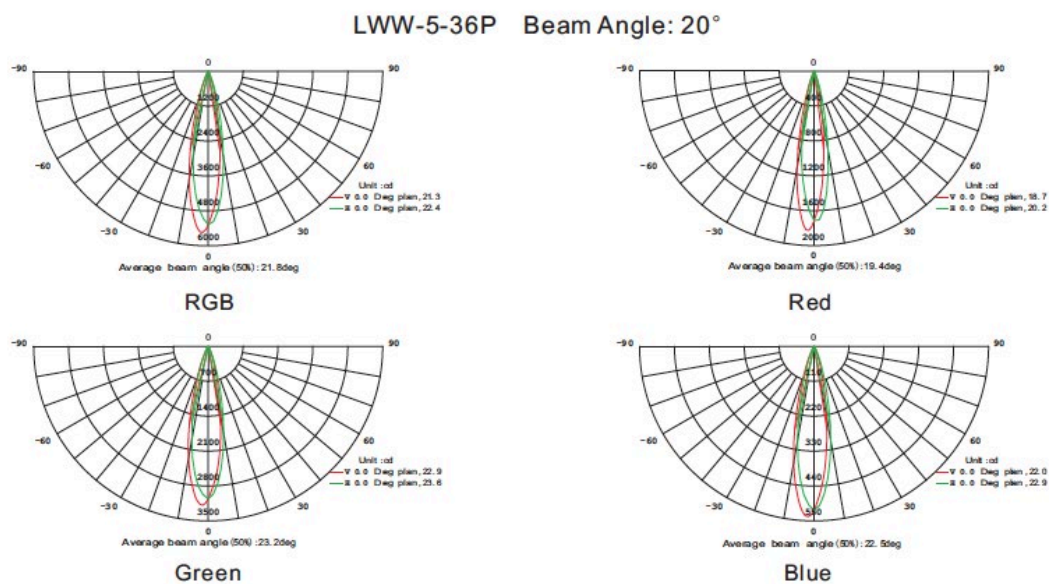

# 22.8" ColorWash LED Wall Washer ETL Rated

## D. Photometric Parameters

### D-1. Cadela Distribution

LWW-5-36P Beam Angle: 20°

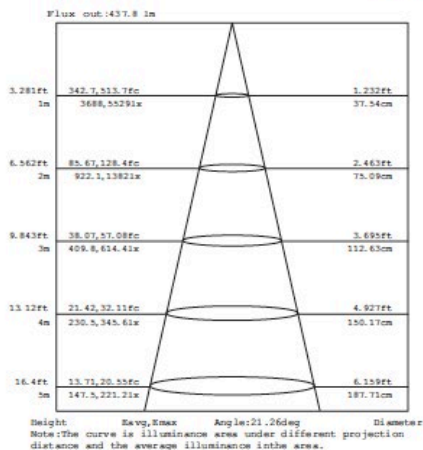

RGB

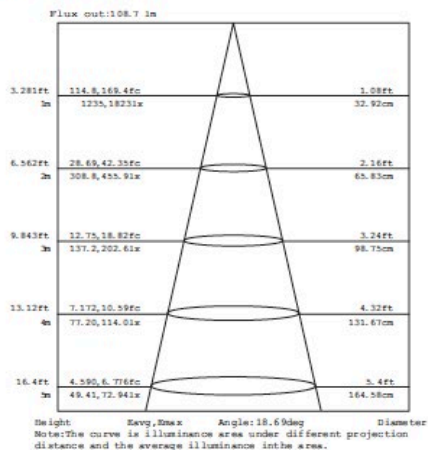

Red

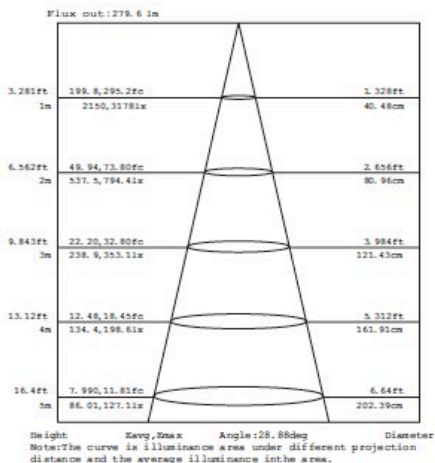

Green

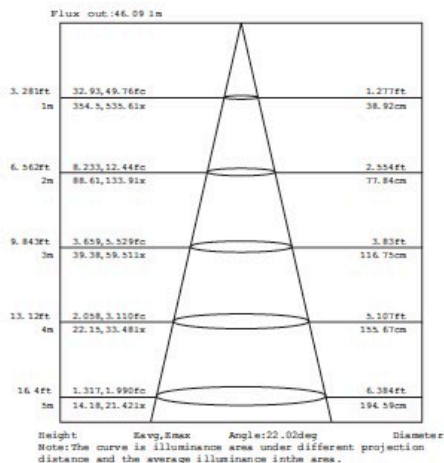

Blue

## E. Dimension Drawing

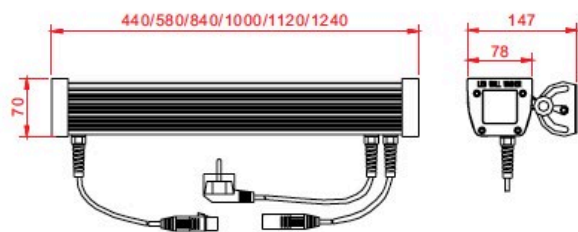

LWW-5B Side mounting leg

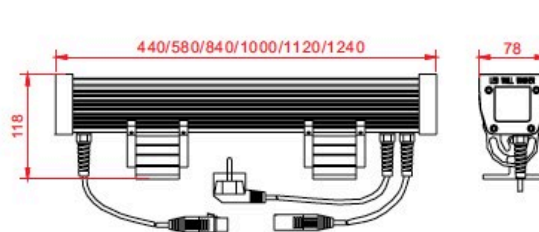

LWW-5C Bottom mounting leg

# 22.8" ColorWash LED Wall Washer ETL Rated

## E. Dimension Drawing

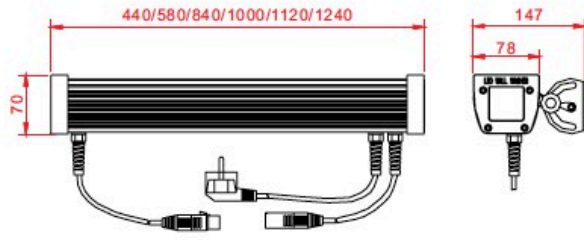

LWW-5B Side mounting leg

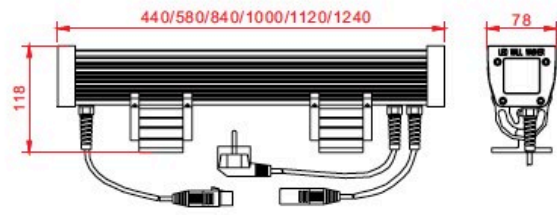

LWW-5C Bottom mounting leg

## F. Installation Drawing:

Fix the brackets via M4 tapping screw, mounting size as below

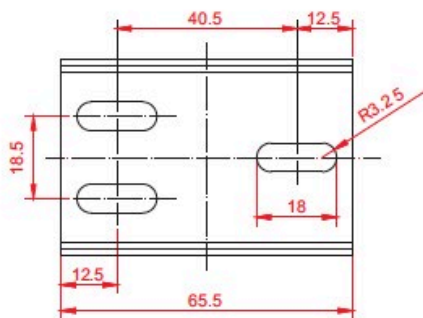

LWW-5B Mounting Hole

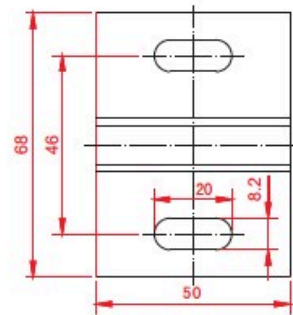

LWW-5C Mounting Hole

## G. Connection

**G-1.** Signal max connection is 100m, more than 100m or 60pcs fixtures need a signal amplifier.

**G-2.** Optional controller: MASTER PRO、Sunlite、DMX-192C、Madrix and other DMX controller.

# 22.8" ColorWash LED Wall Washer ETL Rated

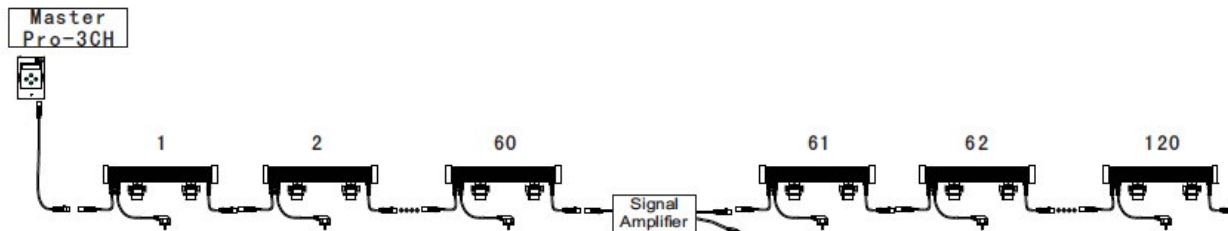

Connection

## H. Waterproof Treatment

The signal output connector XLR-3 of the last fixture of each series must be sealed with a 20mm thermal shrinking tube(-1), blow and shrink it with a hair driers; thence wrapped with waterproof tape (auto-adhesive, please refer to below instruction for operation) on both side; Blow the second 25mm shrink tube(-2) at last so as to protect waterproof tape under sunshine and guarantee the waterproof validity.

Le connecteur de sortie du signal XLR-3 du dernier appareil de chaque série doit être scellé avec un 20mm Stube rétrécissement thermique (-1), souffler et rétrécir avec cheveux séchoirs, de là enveloppé avec du ruban adhésif étanche (auto-adhésif, s'il vous plaît se référer au-dessous de l'instruction pour le fonctionnement) sur les deux côtés; Soufflez le deuxième tube de 25mm de retrait (-2) à durer de manière à protéger la bande imperméable à l'eau sous le soleil et garantir la validité étanche.

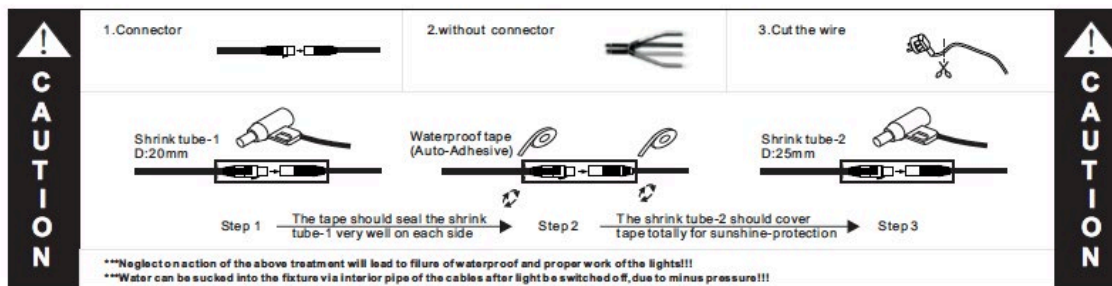

\*\*\* Power connector should be treated in the same way if available!!!

### Caution:

1. Do not plug them into power when the product is still in package;
2. Don't use anything to cover the fixture during application;
3. Don't use this product in close environment;
4. If this product appears to be damaged, do not attempt any repair, please contact your dealer.

### Warning:

- \* Neglect on action of the above treatment will lead to failure of waterproof and proper working of the lights!!!
- \* Make sure the ground connection well avoid electric shock, due to metal housing.