



WiedaMark

StarMax Fiber Optic RGBW Star Lighting Systems.

STARRY STAR PANEL.

Welcome the heavens to your home with your new Star feild ceiling. Your system will include the following:

- Acoustical fiber optic panels
- Rotofast anchors
- 10 Feet of Low voltage RJ45 / CAT5 jumper cables
- Lead wire(s)
- Hex tools – poker tool
- Anchors
- 12V @ 100 WATTS power supply (average 12 panels) | 24V@100WATTS (average 24 panels)
- Spacers (optional—Used mostly when back lighting the panels with LED strips to create a halo effect on ceiling or wall)* Spacers are also used should your installation require additional room for wiring

* Some installers use spacers for standard installation requiring more room for wires.

Note: Sometimes there will be more than one lead wire and sometimes the wire(s) will already be attached to the power supply.

POWER SPECIFICATIONS:

Each panel draws 12Volts and 7Watts.

Note: Some panels will come with a shooting star which contains two (2) Star Panel Board light sources and will increase the panel power another 7W, for a total of 14Watts@12V.

POWER SPECIFICATION FOR STAR PANEL

UL Listed 12V@100W power supply. which can control up to 12 star panels. If there are more panels please add a larger wattage 12 to 24V transformer with an additional Masterboard. (please see page 6)

CONTROLLABLE VIA:
WIFI OR BLUETOOTH OR RS232
ALEXA / GOOGLE HOME Please specify

WEAR LATEX GLOVES TO KEEP PANELS
CLEAN WHILE HANDLING!

RGBW STAR WIRING DIAGRAM

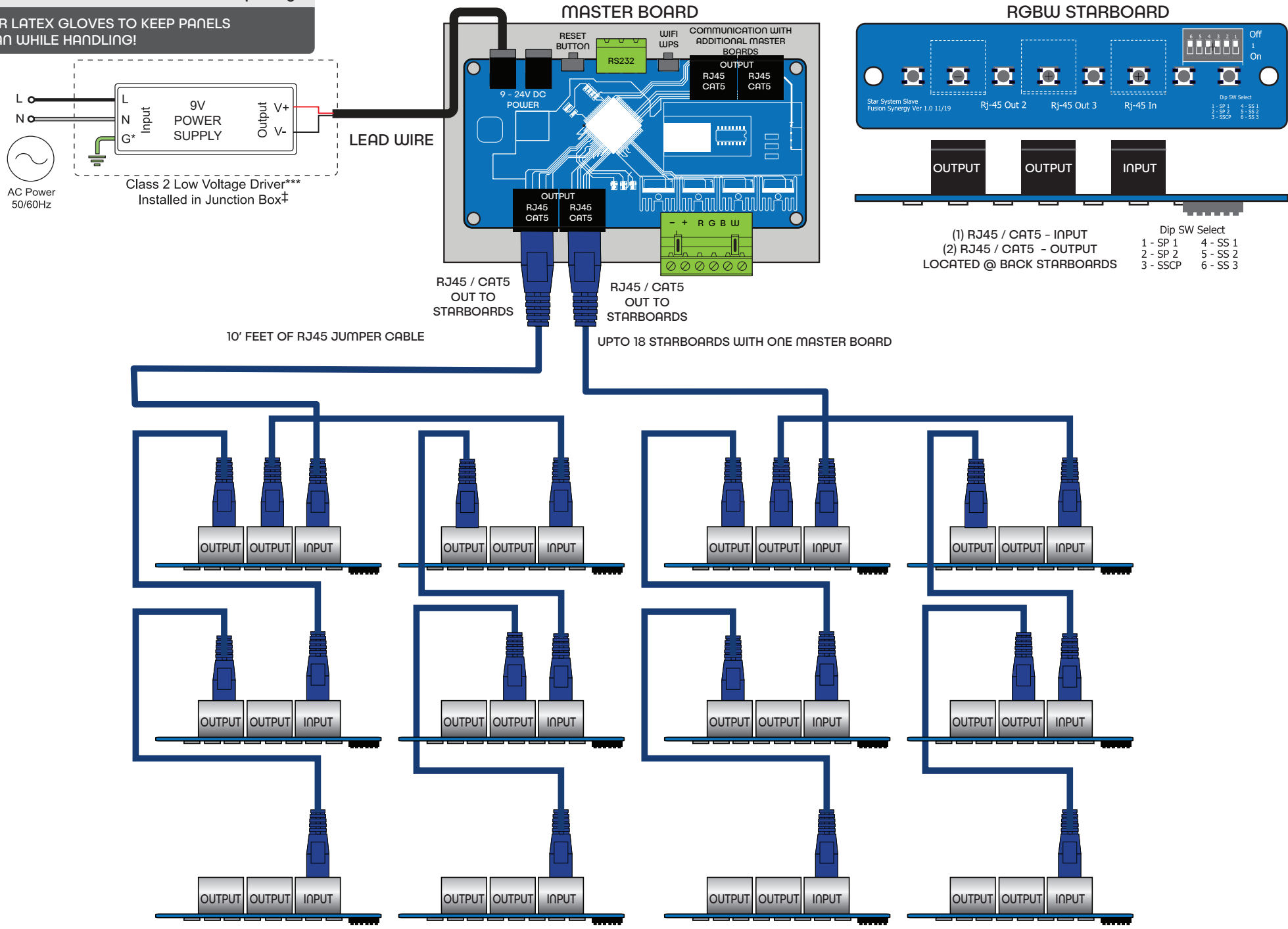

INSTALLATION (with 2 people using a stepladder):

Square up the room. A room may look square, but it doesn't mean that it is square. Measure twice since all the panels are aligned off of the first panel. Its alignment in the room is critical. Being just a little out of square with the first panel could result in being way out of square when you get to the end of the room. Take your time squaring up the first panel. Using masking tape, pencil marks, and chalk lines will assist you in keeping the installation square and true. Locate where your first panel will be installed.

It is imperative for a successful installation to have squared your room through proper measurement. All panels are aligned off the first unit so its placement is key to insure a successful installation.

RUNNING THE POWER:

Connect or Run the power by using one of the two options. The choices are to place driver in a remote location or place it embedded within the panel space. The remote driver option is the preferred option due to avoiding running power cables within spaces that typically requires an electrician.

TIP: After you finish running the power and lead wires run, test every panel before it goes up by plugging lead wire to the LED Motherboard located in the star panel.

OPTION 1: REMOTE DRIVER (RECOMMENDED METHOD)

The power supply has connectors for a power cable for the input of the line voltage. The selected outlet for powering the Driver should be controlled from a remote switch or control system. Locate the Driver in a proper equipment area that is accessible and within 50 feet of the first star panel (generally in the center of the ceiling). At this point, connect the Star Panel Leader Cable and start daisy chaining the panels together using the supplied Jumper Cables. Your leader cable should not be longer than 50 feet. Consult with the Star Panel manufacturer if a longer leader cable is required.

OPTION 2: EMBEDDED DRIVER

Only a licensed electrician should embed the Driver into the ceiling. It may be necessary to install a Driver into an approved electrical enclosure where the line voltage is already located in the ceiling and running new low voltage wire is not an option. This may be more common in existing older homes and retro fits. The Driver is a line voltage device and will require access to it (according to most electrical codes); therefore, a cut out in the panel will be required to access the Driver. Use the Cut Out Kit (optional) to mark and cut the panel. (Check and observe local building codes.)

TIP: After you finish installation of the power supply and lead wire run, test every panel before it goes up by plugging lead wire to LED board located in the center of the panel.

MOUNTING THE FIRST PANEL

TIP: You can use a paint brush extension (available at most hardware stores) to hold the panel in place.

Rest the Drop in Panels into position by tilting them slightly and lifting them above the framework then letting them fall into place. When positioning the first panel, it is recommended to start from the center and work your way to the walls.

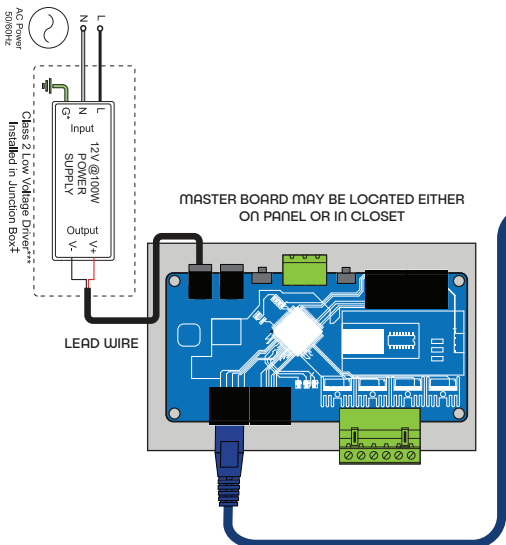

Up to 12 panels can be connected together in any configuration per lead wire. If your installation requires more than 12 panels, you will need an additional lead jumper wire and may need to add an additional Power Supply and MASTERBOARD.

See Power Specifications Page.

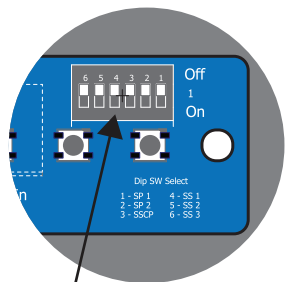

DIP SWITCH SETUP FOR THE STARBOARD

- 1 - STAR PANEL
- 2 - STAR PANEL
- 3 - SHOOTING STAR CROSS PANEL
- 4 - SHOOTING STAR 1
- 5 - SHOOTING STAR 2
- 6 - SHOOTING STAR 3

STANDARD STAR WIRING DIAGRAM W/SHOOTING STAR

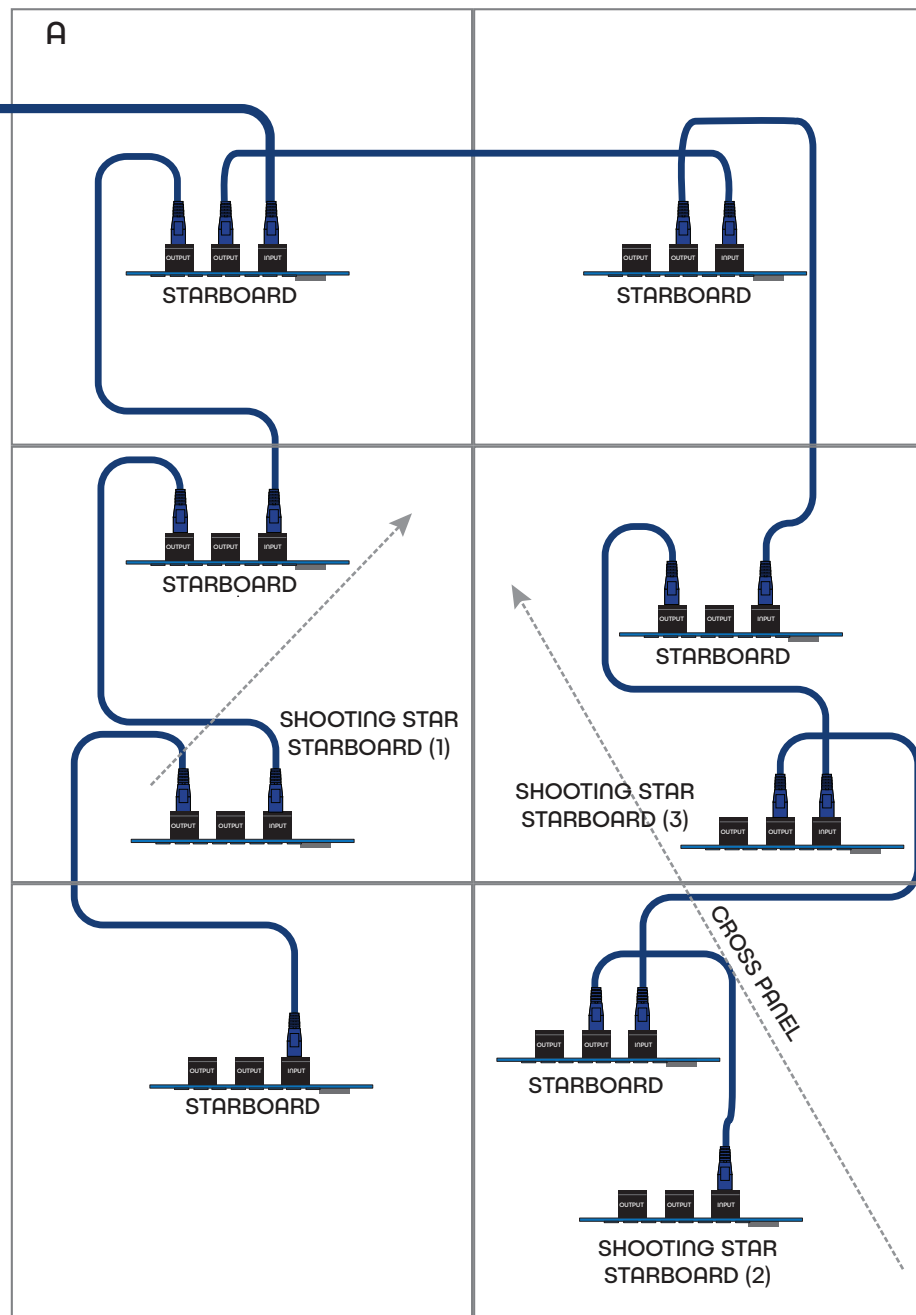

BIRDS EYE VIEW

DIAGRAM BELOW IS AN EXAMPLE WIRING DIAGRAM FOR A BASIC STAR PANEL CONFIGURATION. ELEMENTS SHOWN ARE NOT TO SCALE.

OTHER SHOOTING STAR PANEL CONFIGURATIONS

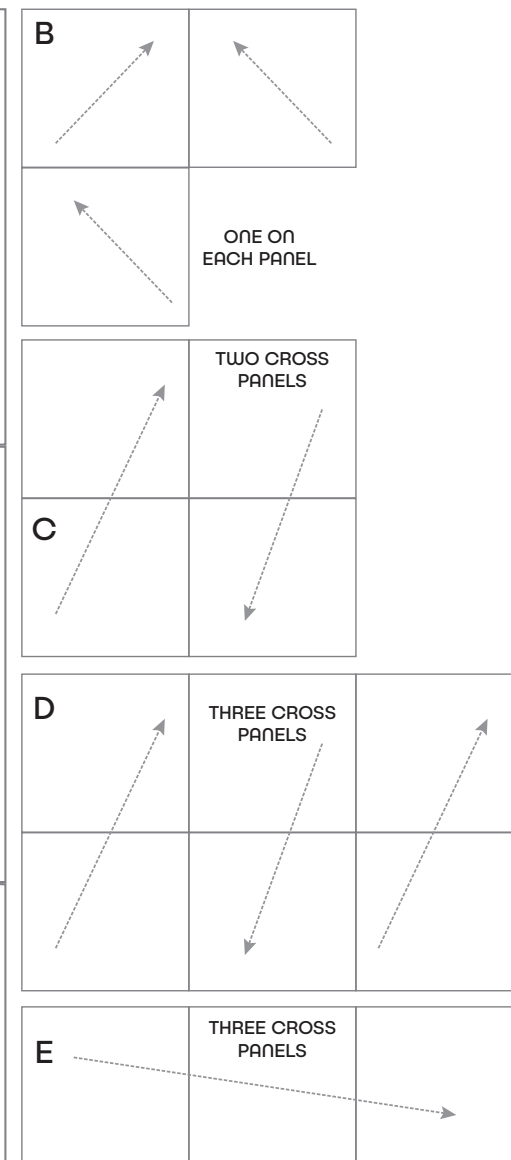

STANDARD STAR WIRING DIAGRAM W/SHOOTING STAR AND RGBW PERIMETER STRIP LIGHTS FOR HALO EFFECT

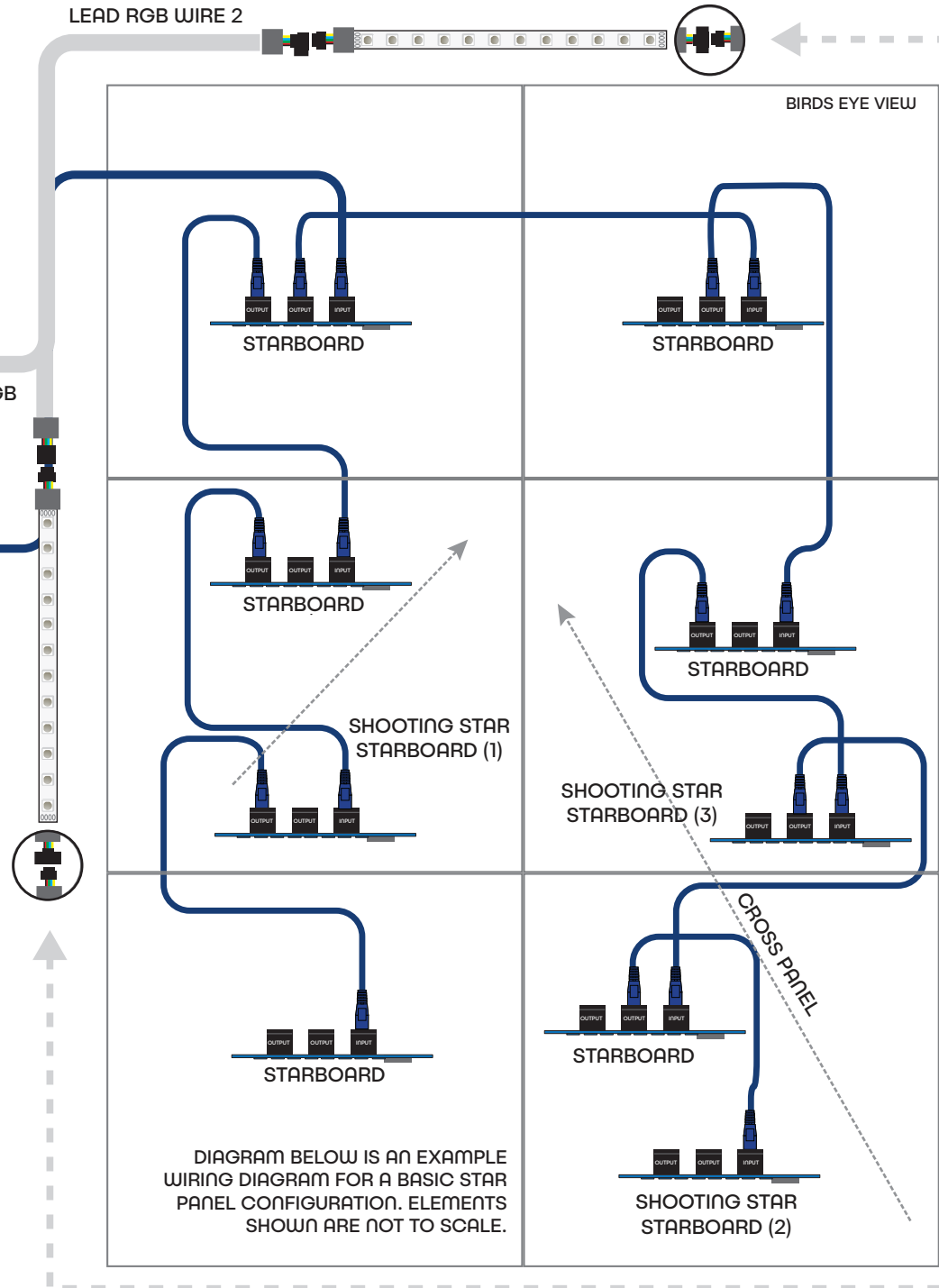
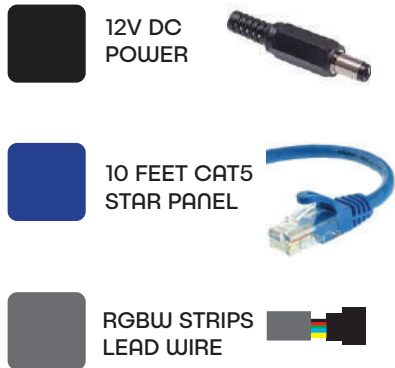
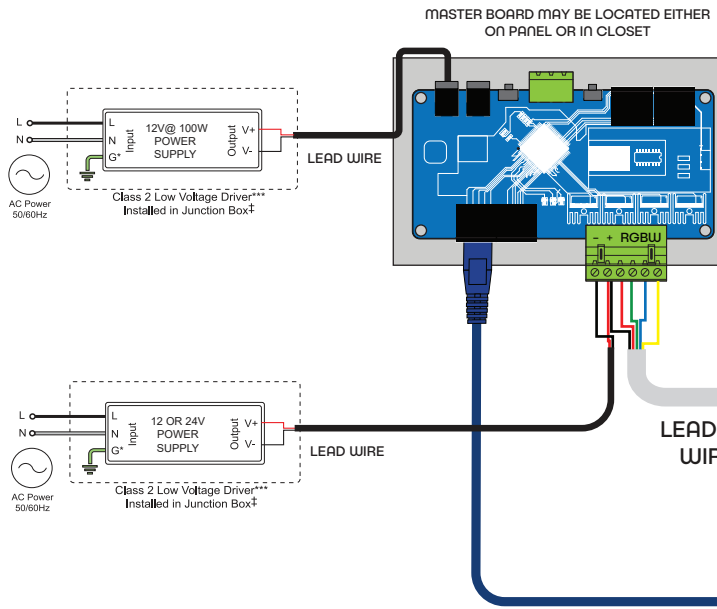

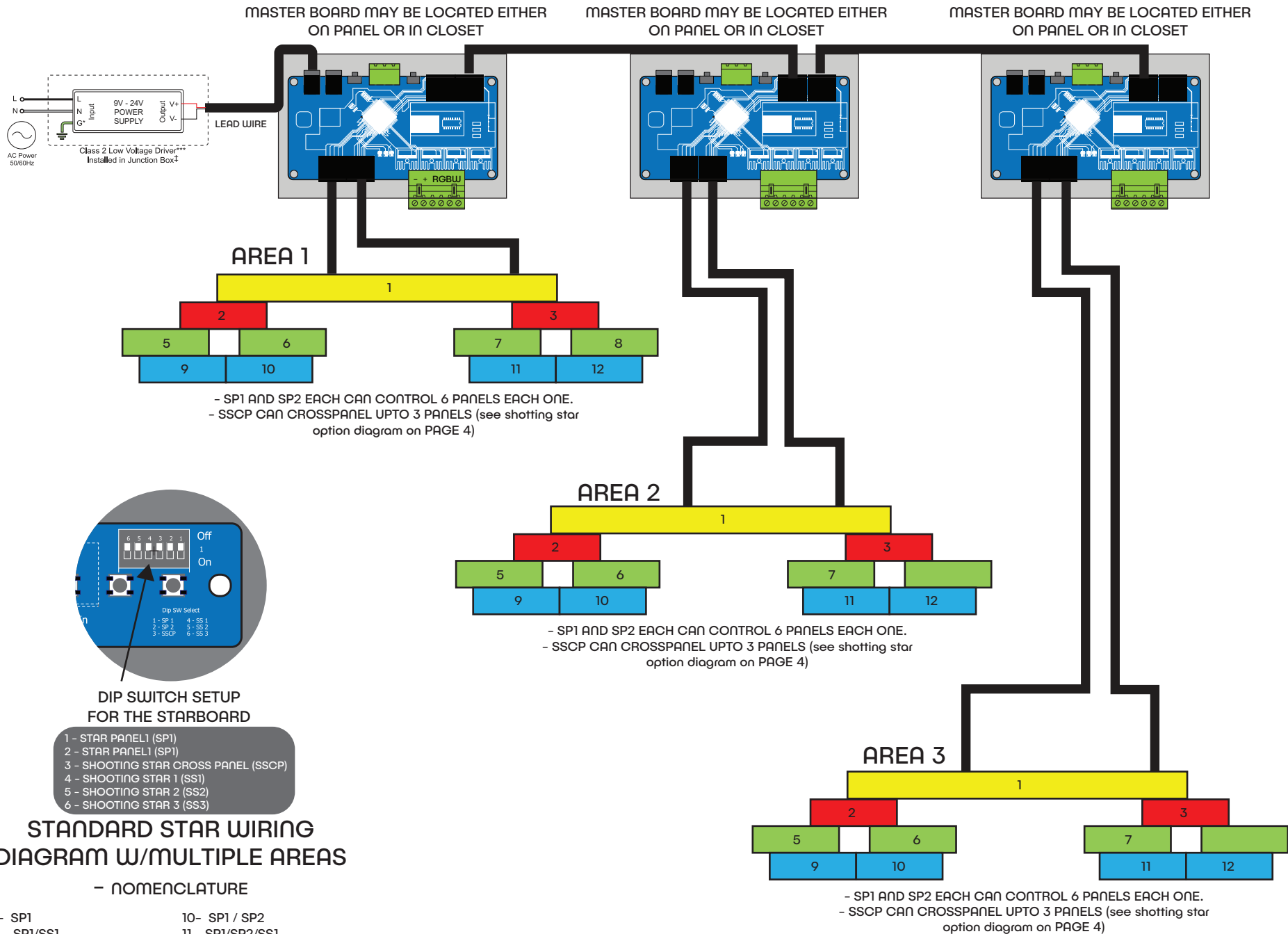

INSTALLATION STEPS

1. The most important part of installing our star ceiling panels are measuring and snapping the ceiling grid chalk lines.

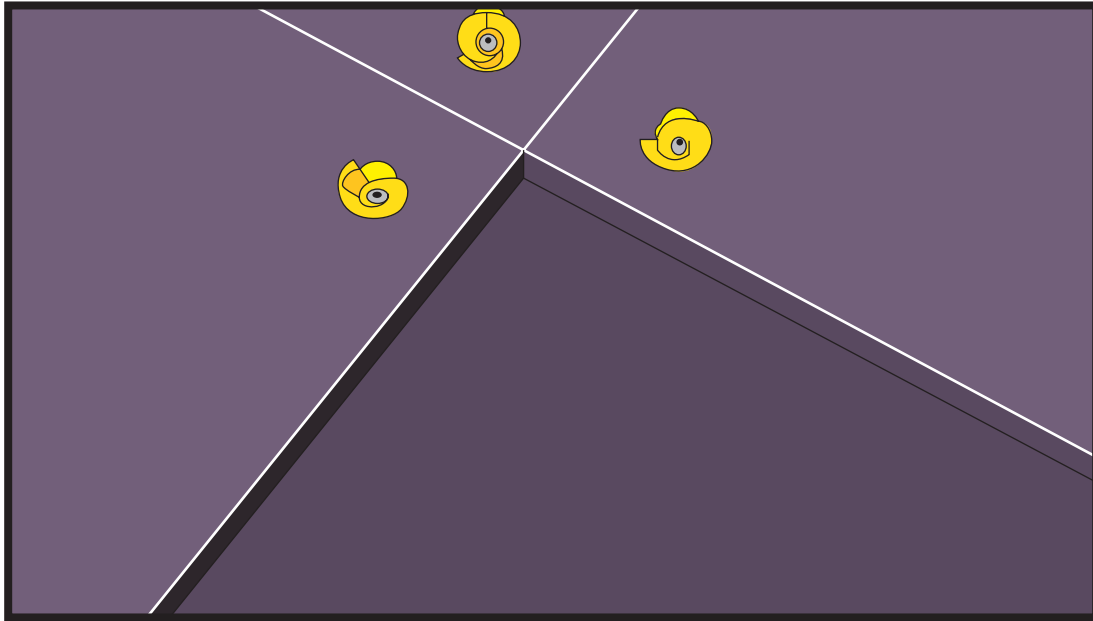

2. Here are the basic components: dry wall anchor, screw, spacer and a rotofast. The anchor is screwed into the drywall and then the rotofast and the spacer are placed on the screw and screwed into the anchor. The hex head of the rotofast is then snapped into place to allow the hex wrench to turn the rotofast from below the star ceiling panel.

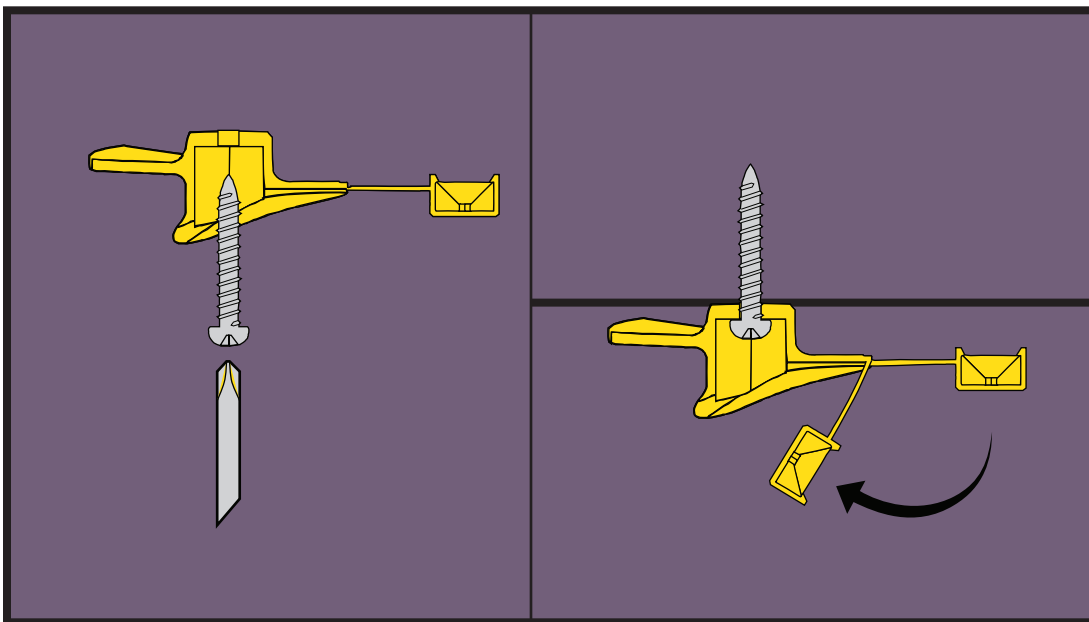

* Optional: 3. Begin by placing the edging strip around the boundary of the ceiling. It's important that each piece is installed tight and flush to the previous one so the ceiling panels line up correctly.

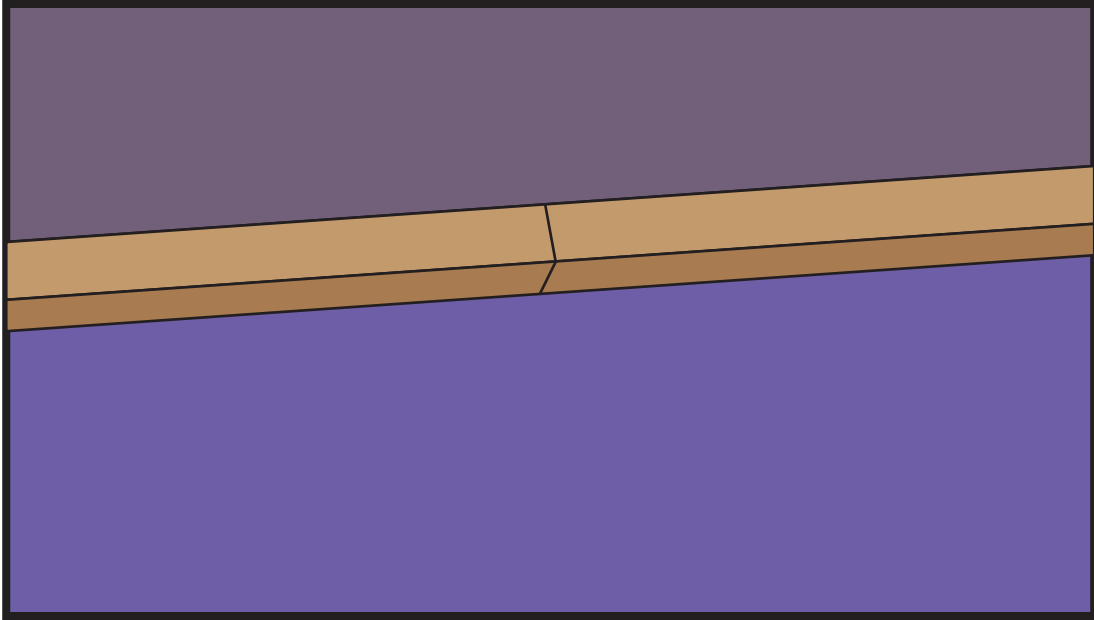

4. After placing the edging strips, we can measure for the ceiling grid chalk lines. These must be exact because they show where the rotofast anchors are placed. With laser measurements, determine the ceiling centers and snap those grid lines. Then, we can measure and snap lines for each ceiling panel

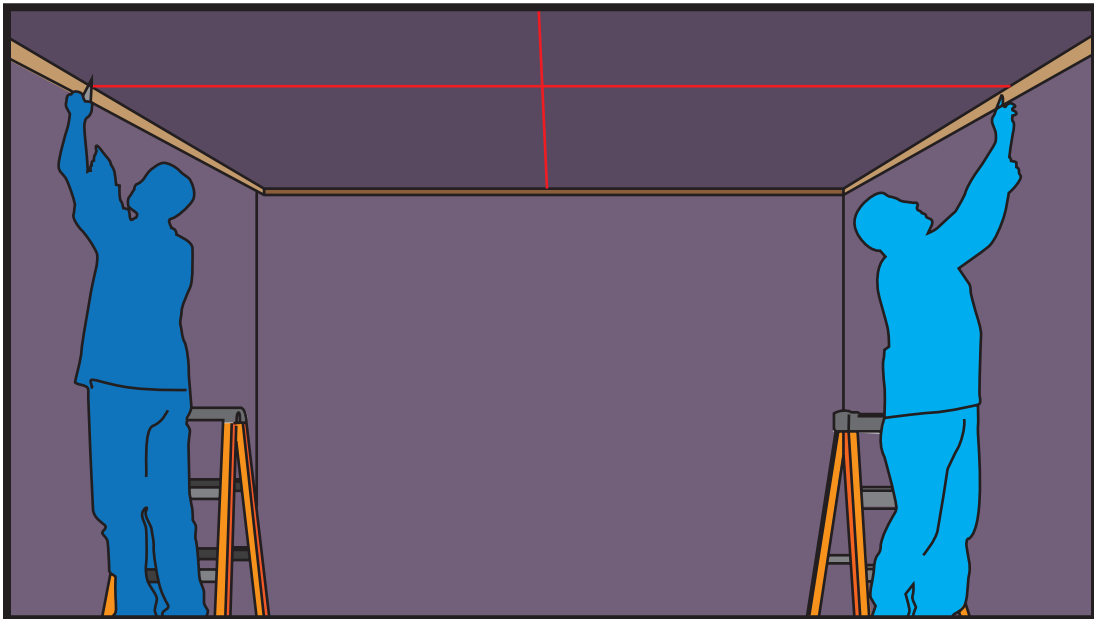

5. Exact measurements are critical because they place the exact points of the rotofast panel fasteners. Take your time, measuring and marking the chalk line snap points. And it's good to confirm your measurements. Measure twice, snap once. The rotofasts are installed 4 inches from each grid corner with one at the center of the long side of each panel. Notice that the panels have had any openings pre-cut before installation and each panel has Rotofast markings 4 inches from each edge in the corners and center.

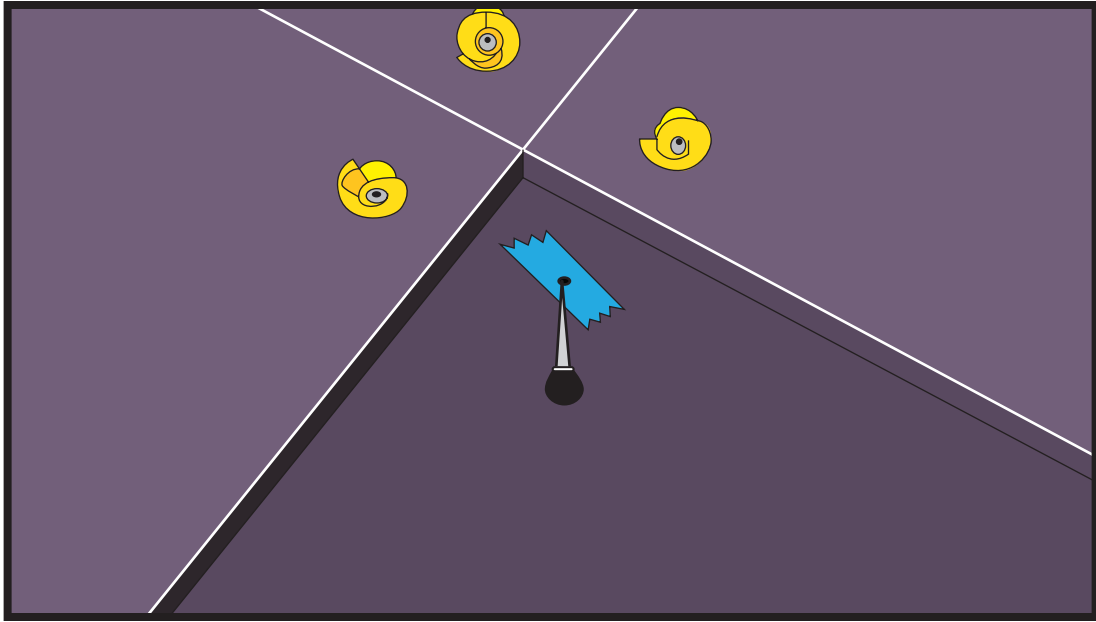

6. After the power cable is connected and checked, the panel is ready to lift into position. Therefore, two people are needed for the installation. Then, carefully position the panel in place. Again, the panel each have a rotofast position marked on masking tape pieces on the panel face 4 inches from each corner and center edge. The panels are somewhat fragile, so go slowly.

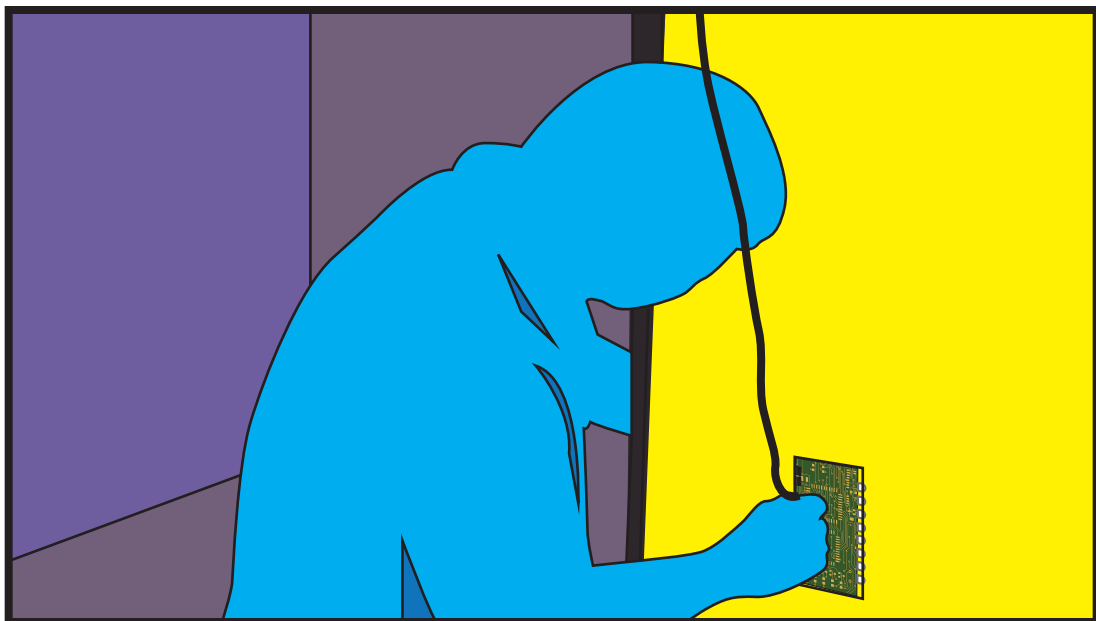

7. When the panel is fully in place and aligned, the rotofast from each corner can be engaged. This is done with a hex wrench inserted through the face of the panel at the mark. The hex wrench is rotated counter-clockwise to screw the rotofast in the panel material. A little pressure while turning helps seat the fastener into the material. An ice pick is used to locate the exact position of the hex nut in the rotofast. Then, the hex wrench can be inserted into the hex nut to slowly turn the rotofast. Make sure to level the panel face with the edging strip and the other panels.

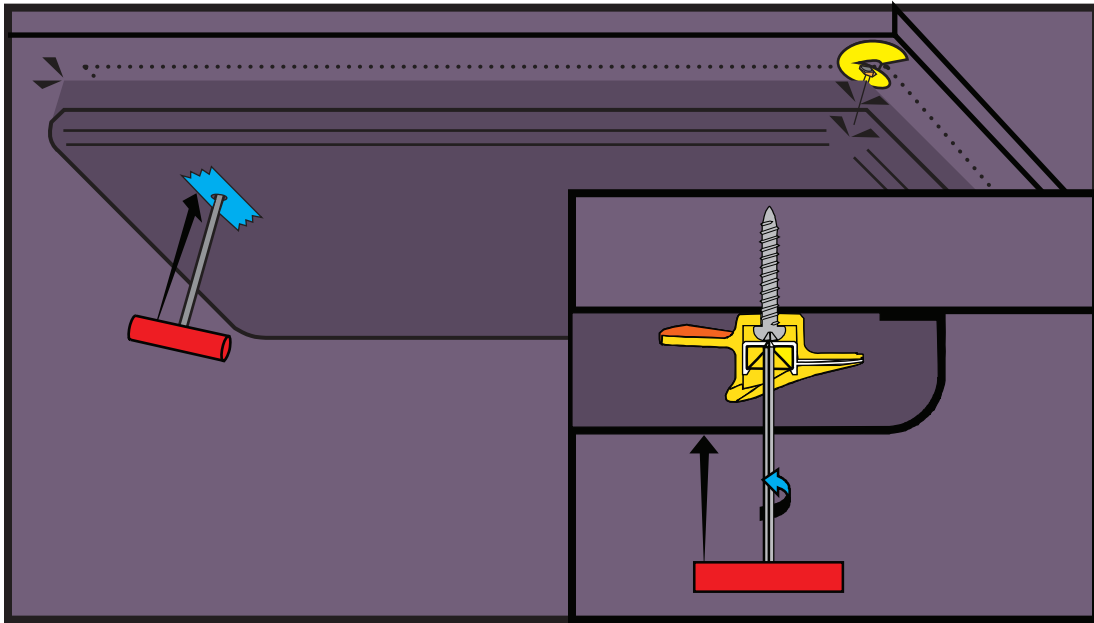

8. When the panels are in place they can be leveled with each other for a smooth surface across the corners. This process is repeated at each corner of the panel while the panel is held in place by a second person. Gentle pressure combined with the slow turns of the hex wrench is the correct way to install the panels. It might take a few seconds to find the center of the hex nut in the rotofast, but once it's found, the hex wrench can be inserted to engage the fastener. Turn counter-clockwise to raise the panel and clockwise to lower it, turn slowly, rotofast can be over-rotated .

9. After the four corner are secured the center panel rotofasts can be engaged to level the middle sections. Remember, pre-cut the panel openings exactly measure and mark the rotofast positions use a minimum of 2 people to carefully install each panel and level them for a smooth surface when correctly installed, the Star ceiling panel is a dramatic scenery to any room.

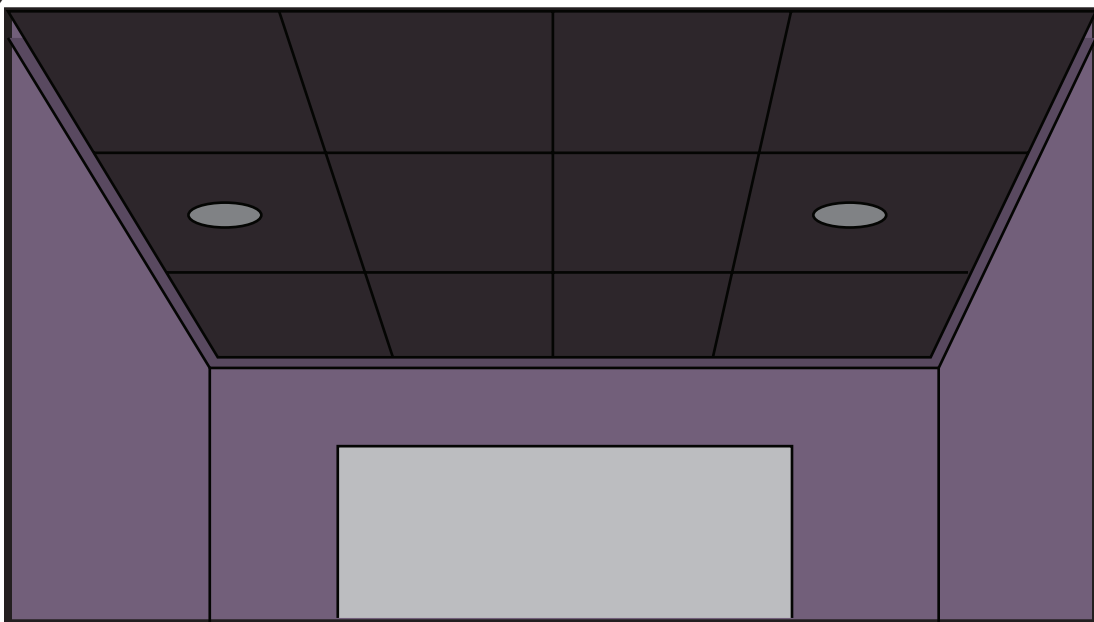

ILLUMINATE 1.0 STANDARD STAR CONTROL SYSTEM

BLUETOOTH CONTROL VIA PHONE OR WIFI INTERFACE:

1. Download the **ILLUMINATE 1.0** app from the iOS APP STORE or GOOGLE PLAY STORE
2. Make sure your BLUETOOTH is on (if not the app will prompt you to turn on bluetooth)
3. Once launched proceed to adjust the setting that you want

SCREEN SHOT



APP ICON
IN STORES

 CONTROLS THE
STAR CEILING

 CONTROLS THE
AMBIENT LIGHTS

BUTTONS TO KNOW

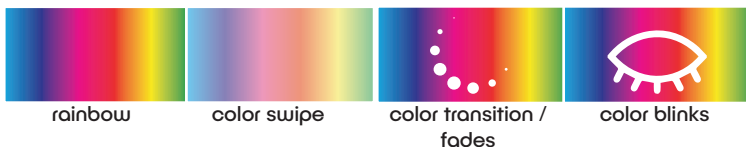

SS1 shooting star 1
(customer orders one shooting star)

SS2 shooting star 2 (customer orders 2 shooting stars)

SS3 shooting star 3 (customer orders 3 shooting stars)

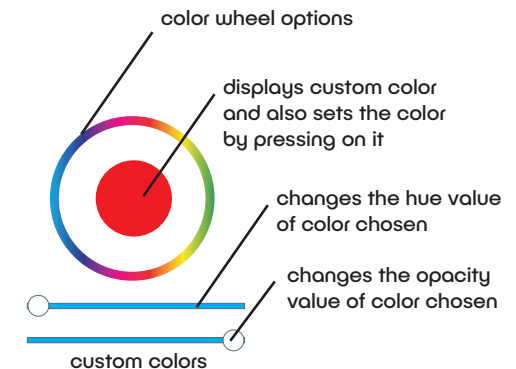

CONTROLLING STARRY NIGHT EFFECTS

HOME PAGE



MOUSE OVER OVER

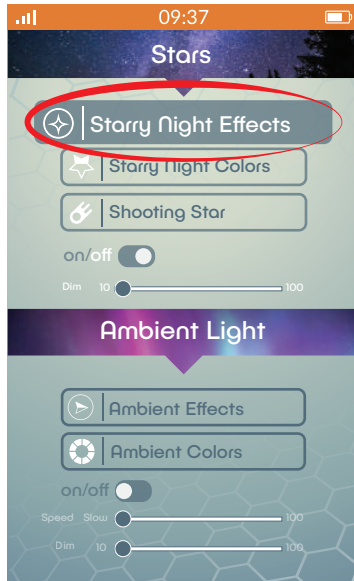

EFFECTS PAGE

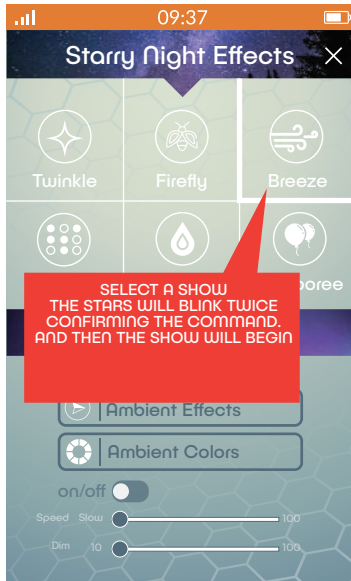

UPDATED HOME PAGE

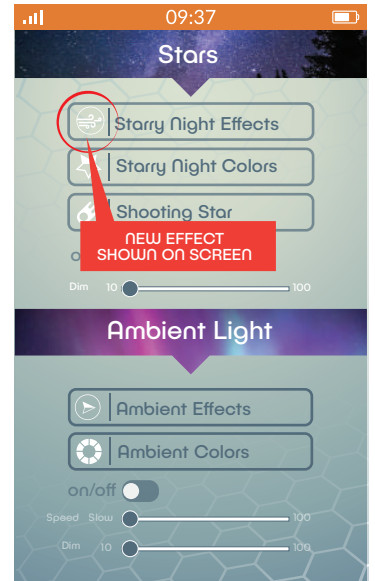

CONTROLLING STARRY NIGHT COLORS AND EFFECTS

HOME PAGE

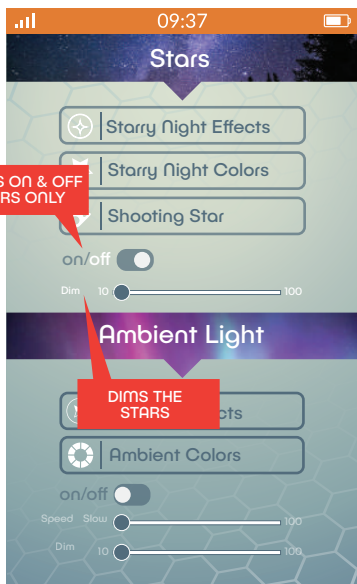

MOUSE OVER OVER

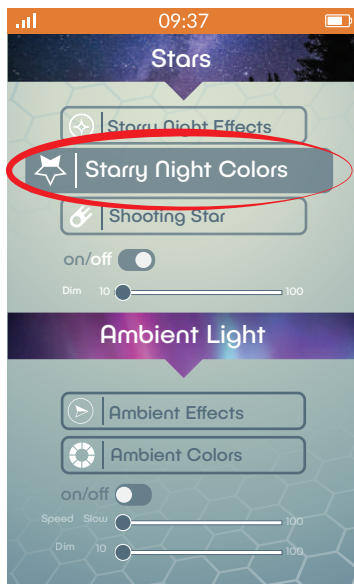

COLOR SELECTION PAGE

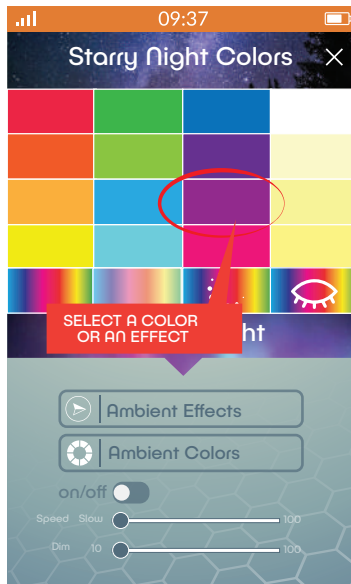

UPDATED HOME PAGE

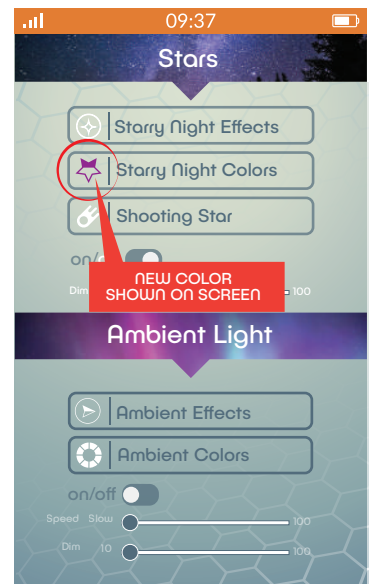

CONTROLLING SHOOTING STAR

HOME PAGE



MOUSE OVER

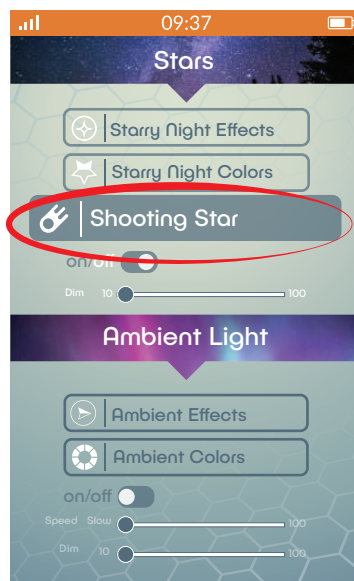

SHOOTING STAR PAGE

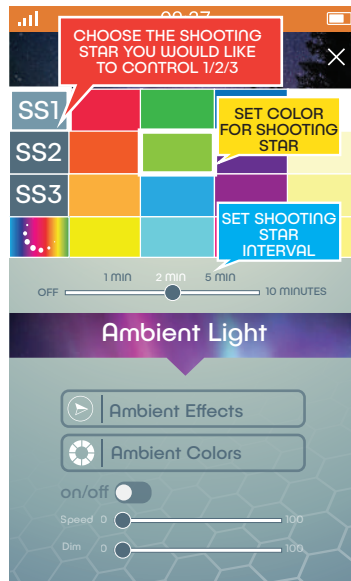

UPDATED HOME PAGE

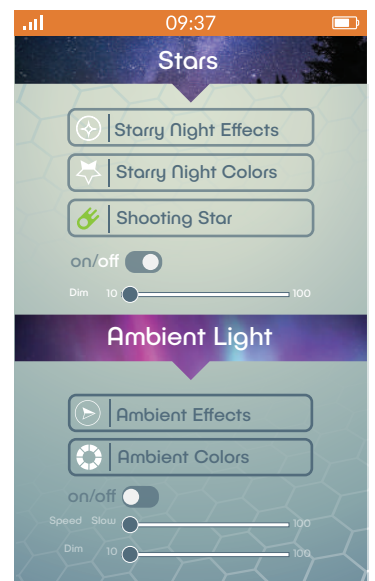

CONTROLLING AMBIENT LIGHT EFFECTS

HOME PAGE



MOUSE OVER OVER

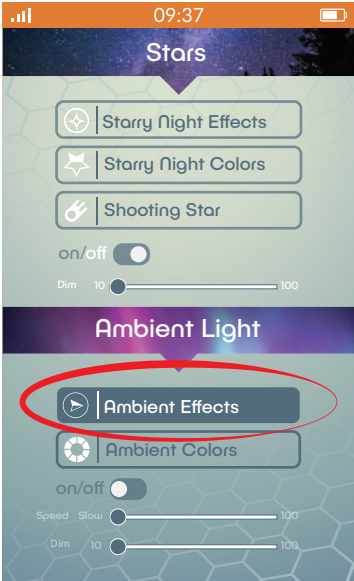

AMBIENT LIGHT EFFECT PAGE



UPDATED HOME PAGE



CONTROLLING AMBIENT LIGHT COLORS

HOME PAGE



MOUSE OVER OVER

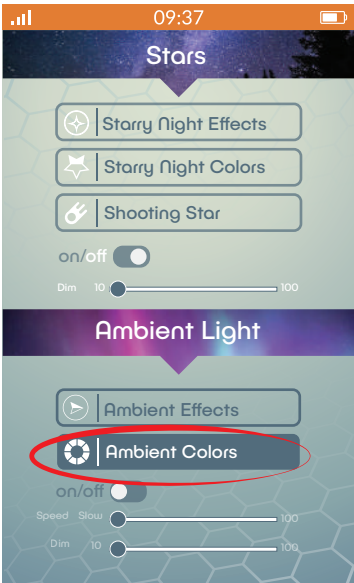

AMBIENT COLOR PAGE



CUSTOM COLOR PAGE



UPDATED HOME PAGE



Starpanel System RS232 Commands

Effect	Commands
--------	----------

Stary Night Effects

Twinkle	T
Firefly	F
Breeze	B
Random	R
Rain Drops	P
Jamboree	J

Stary Night colors (c,R,G,B,W*)

Red	c,255,0,0,0*
Orange	c,255,50,0,0*
Amber	c,255,150,0,0*
Yellow	c,255,255,0,0*
Green	c,0,255,0,0*
Light green	c,0,255,150,0*
Lime	c,0,255,50,0*
Aqua	c,0,255,255,0*
Blue	c,0,0,255,0*
Violet	c,150,0,255,0*
Purple	c,255,0,200,0*
Pink	c,255,0,50,0*
White	c,0,0,0,255*
Warm White	c,202,218,255,0*
Natural White	c,255,246,237,0*
Cool White	c,255,193,141,0*
Wipe color	w
Fade color	f
Rainbow color	r
Blink color	b

Dimmer stars (D,%*)

% is range between 10 to 100

example dimm 80% D,80*

Shooting Stars (Zone,color,time*)

Zone

Zone 1 (SS1)	X
Zone 2 (SS2)	Y
Zone 3 (SS3)	Z

Color

Red	255,0,0,0
Orange	255,50,0,0
Amber	255,150,0,0
Yellow	255,255,0,0
Green	0,255,0,0
Light green	0,255,150,0
Lime	0,255,50,0
Aqua	0,255,255,0
Blue	0,0,255,0
Violet	150,0,255,0
Purple	255,0,200,0
Pink	255,0,50,0
White	0,0,0,255
Warm White	202,218,255,0
Natural White	255,246,237,0
Cool White	255,193,141,0

Time

off	0
1 Minute	1
2 Minutes	2
5 Minutes	5
10 Minutes	10

Close command *

Example

Zone 1 red color 1 minute X,255,0,0,0,1*

Zone 2 blue color 10 minutes Y,0,0,255,0,10*

Zone 3 green color 2 minutes Z,0,255,0,0,2*

Off SS1 X,0,0,0,0,0*

Off SS2 Y,0,0,0,0,0*

Off SS3 Z,0,0,0,0,0*

Ambient Light Effects

(mode,speed)

speed is range between 255 to 150 (255 = fast /150 =slow)

Fade e,speed

Blink k,speed

No Effect n

example

fade fast speed e,255

fade slow speed e,150

blink fast speed k,255

blink slow speed k,150

Ambient Light colors

Red A,255,0,0,0*

Orange A,255,50,0,0*

Amber A,255,150,0,0*

Yellow A,255,255,0,0*

Green A,0,255,0,0*

Light green A,0,255,150,0*

Lime A,0,255,50,0*

Aqua A,0,255,255,0*

Blue A,0,0,255,0*

Violet A,150,0,255,0*

Purple A,255,0,200,0*

Pink A,255,0,50,0*

White A,0,0,0,255*

Warm White A,202,218,255,0*

Natural White A,255,246,237,0*

Cool White c,255,193,141,0*

Dimmer strip color

(d,%)

% is range between 10 to 100

example dimm 80% d,80

Field Cutting Star Panels

To field cut star panels for protruding objects, as you're installing the panels, mark the location of the protrusion on the upper side of the panel. Remove any fibers in the area and use our poking tool to re-insert them elsewhere in the panel. Then carefully cut only the 1" Fiberglass for the measured opening with a sharp non-serrated knife or box cutter, making sure not to cut the fabric below. Then, make an "X" in the fabric below and fold the 4 fabric flaps up into the opening, gluing them over the top of the panel to create a finished area, using a light adhesive spray, such as 3M Super 77 spray. You can also field cut for speakers and air vents, but you leave the fabric intact and reinsert the fiber strands through the fabric, after cutting only the Fiberglass on the panel.

To field cut star panels that are slightly larger than the installation area, you first "un-rap" the fabric on the side that you need to shorten. Mark the new line to cut on top of the fiberglass panel and remove and re-locate any fiber optics in the area. Being careful not to nick any fabric, cut to the new size with a sharp non-serrated knife or box cutter. Then re-wrap the fabric over the top with slight tension, using a light adhesive spray such as 3M Super 77 spray to tack the fabric back over the top of the panel edge.

Warranty Information

With purchase of our star panels, there is a 1 Year Manufacturer's Warranty. This guarantees that any products with defects in materials and/or workmanship will be repaired or replaced by the manufacturer for a period of 1 year from the date of purchase. During this warranty period, the manufacturer will replace or repair any defective parts and correct any defect in workmanship without charge for parts and labor. For warranty labor, contact us, as any reimbursement must be pre-approved by us before proceeding. We will not cover any warranty labor that has not been pre-approved and performed by a qualified provider. For this warranty to apply, the products must be installed and used in accordance to its written instructions. Damage to, or destruction of any product caused by the end user is not covered by this warranty. Additionally, normal wear and tear are not covered by this guarantee.

Shipping Damage is Not Covered under this Warranty. All shipments received by you that seem damaged, must be noted to the freight carrier, then refused and returned to the address on your shipping label for claim processing. You must report any damage claims immediately so that the party responsible for the damage can make amends. We will not be held responsible for any shipping damage and you may have to claim freight damage with your own insurance company, if you do not note it with the shipping carrier.

We will not be liable for any implied warranty or merchantability or fitness for a particular purpose to any person other than the original purchaser and user. Under no circumstances will the manufacturer be liable for property damage, economic loss, or any consequential damages sustained in connection with the purchase and use of any products. Some states do not allow limitations on how long an implied warranty lasts, or do not allow the exclusion of limitation of incidental or consequential damages, so the above limitations or exclusions may not apply to you. The manufacturer neither assumes nor authorizes any representative or other person to assume for it any obligation or liability other than such as is expressly set forth herein. This warranty gives you specific legal rights, and you may also have other rights which may vary, from state to state.

