

16 Watt RGBW LED Fiber Optic Illuminator



Technical Data:

Luminous Flux(lm): 500
 Emitting Color: RGBW Lamp
 Body Material: Aluminum Alloy
 Light Source: LED
 Measurements: 4.5 x 2.5 x 2.1 inches
 LED power: 16W RGBW
 Life of LED: 50,000 hours
 Ferrule opening: 20mm
 Fiber cable capacity: 400pcs*0.75mm fiber cable
 Supply Voltage: 110V -240VAC.
 Power Frequency: 50Hz-60Hz.

Our 16 Watt Illuminator was created to provide a powerful alternative for lighting applications where low voltage and brilliant colors are required. Control via a RF remote and includes solid color, color washing & color change effects.

Applications include:

- Ambient lighting down light applications.
- Architectural Lighting Applications: Light more than 50 ft of solid core fiber with neon like color!
- Illuminate up to 100 ft by pumping the fiber from 2 sides.
- Under Cabinet Lighting for residential and commercial uses
- Entertainment Lighting

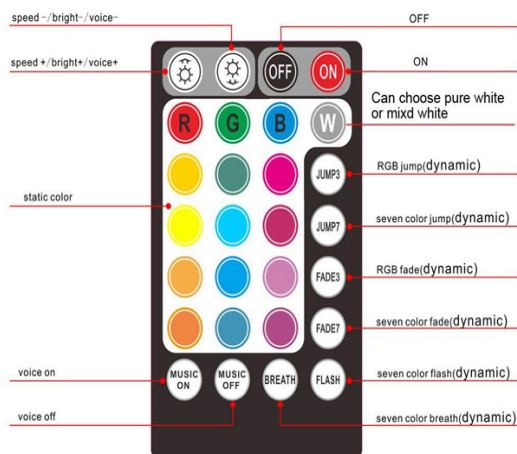

REMOTE PAIRING

Your remote is already paired with the illuminator from the factory. Should you need to replace the remote or if the illuminator has stopped responding to the remote, you may try to pair the remote again.

1. Turn-on the illuminator
2. On the supplied remote, press the FADE3 and FADE7 buttons at the same time.
3. The illuminator should flash WHITE, confirming the pairing is accepted.

16Watt RGBW Light Engine With Sound Activation

BUILT-IN EFFECTS USING THE REMOTE

Built-in effects can be selected by using the buttons on the remote. From these buttons you can access the 12 built-in effects.

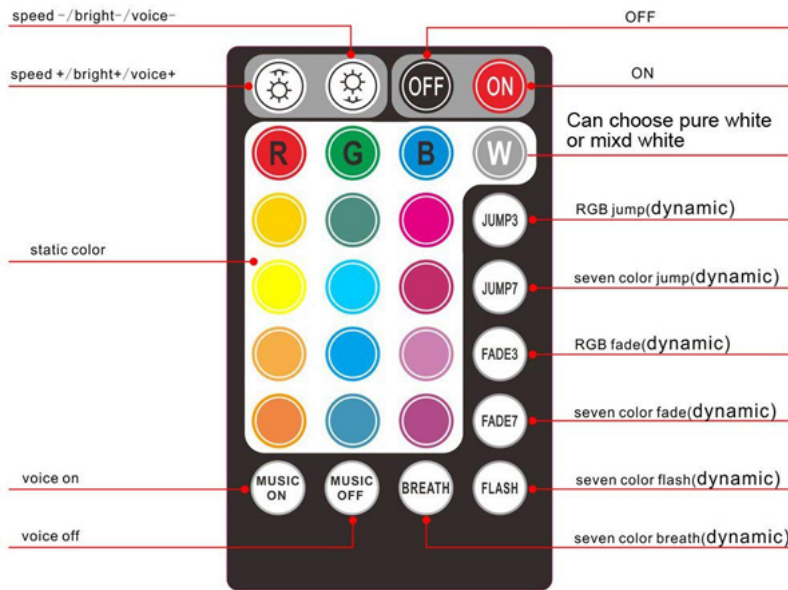

Remote Buttons		Function details
	OFF/ON	Turn OFF/ON the Illuminator
	Speed & Brightness Adjustment	Press this two keys to increase or decrease the brightness in static mode or speed in dynamic mode
	Static Color Selection	Choose a static color
	DIY Brightness adjust	Press the DIY keys to address Green, Red, and Blue color brightness to choose a specific color
	3 Color Jump	Red, Green, and Blue color jump effect
	7 Color Jump	Red, Green, Blue, Yellow, Cyan, Purple, and White color jump effect
	3 Color Fade	Red, Green, and Blue color fade effect
	7 Color Fade	Red, Green, Blue, Yellow, Cyan, Purple, and White color fade effect
	SPARK Dynamic Mode	7 Color flash jump
	White Mode	RGB+White Effect

16 Watt RGBW LED Fiber Optic Illuminator

NUMBER OF FIBER OPTIC CABLES THAT CAN BE INSTALLED

The Fiber Coupler Diameter is 22 mm.



PGConnector inner diameter (mm)	Fiber Diameter (mm)	Max Fiber Number
16-20	0.75	450
16-20	1	250
16-20	1.5	100
16-20	2	60